

Coolant Level Check

To check level, lift hood and look at “see-through” coolant reservoir tank.

It is not necessary to remove radiator cap to check coolant level.

WARNING:

To help avoid danger of being burned:

- do not remove reservoir tank cap while coolant is boiling, and
- do not remove radiator cap while engine and radiator are still hot.

Scalding fluid and steam can be blown out under pressure if either cap is taken off too soon.

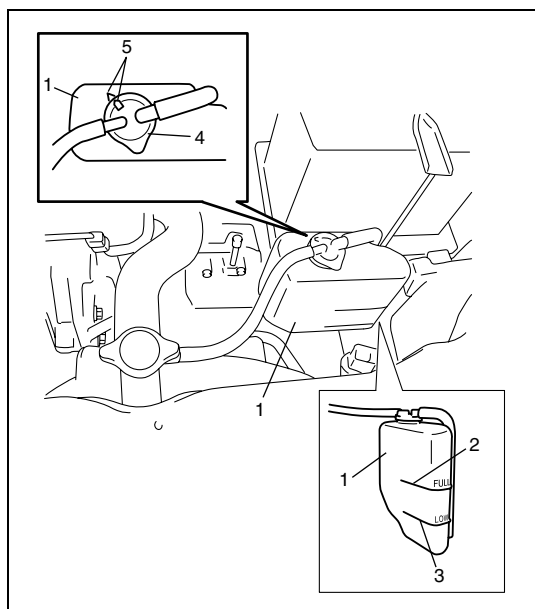

When engine is cool, check coolant level in reservoir tank (1).

A normal coolant level should be between FULL mark (2) and LOW mark (3) on reservoir tank (1).

If coolant level is below LOW mark (3), remove reservoir tank cap (4) and add proper coolant to tank to bring coolant level up to FULL mark (2). Then, reinstall cap (4) and align match marks (5) on tank and cap (4).

NOTE:

- If proper quality antifreeze is used, there is no need to add extra inhibitors or additives that claim to improve system. They may be harmful to proper operation of system, and are unnecessary expense.
- When installing reservoir cap, align arrow marks on reservoir and cap.

Engine Cooling System Inspection and Service

WARNING:

To help avoid danger of being burned, do not remove radiator cap while engine and radiator are still hot.

Scalding fluid and steam can be blown out under pressure if cap is taken off too soon.

- 1) Check cooling system for leakage or damage.
- 2) Wash radiator cap and filler neck with clean water by removing radiator cap when engine is cold.
- 3) Check coolant for proper level and freeze protection.

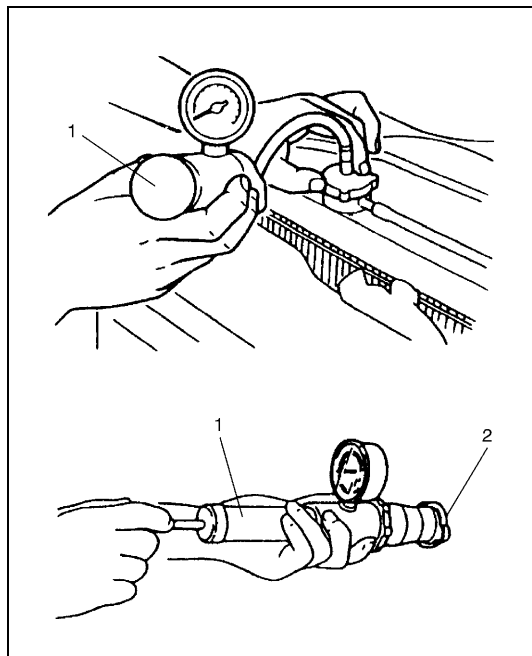

- 4) Using a pressure tester (1), check system and radiator cap (2) for proper pressure holding capacity.
If replacement of cap is required, use a proper cap for this vehicle.

Cooling system and radiator cap holding pressure (for inspection)

: 110 kPa (1.1 kg/cm², 15.6 psi)

NOTE:

After installing radiator cap to radiator, make sure that the ear of cap lines is parallel to radiator.

- 5) Tighten hose clamps and inspect all hoses. Replace hoses whenever cracked, swollen or otherwise deteriorated.
- 6) Clean frontal area of radiator core.

Cooling System Flush and Refill

- 1) Remove radiator cap when engine is cool.
 - a) Turn cap counterclockwise slowly until it reaches a "stop".
(Do not press down while turning it).
 - b) Wait until pressure is relieved (indicated by a hissing sound) then press down on cap and continue to turn it counterclockwise.

WARNING:

To help avoid danger of being burned, do not remove radiator cap while engine and radiator are still hot. Scalding fluid and steam can be blown out under pressure if cap is taken off too soon.

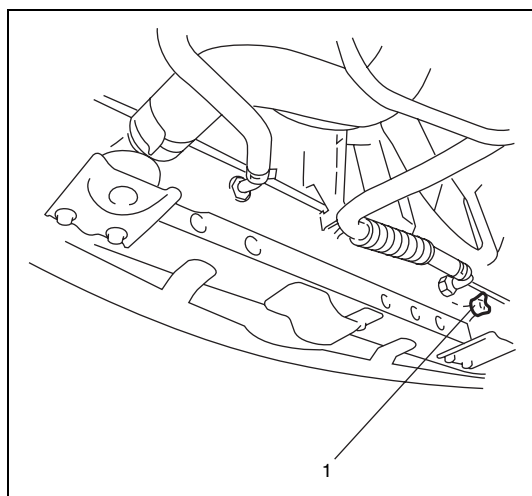

- 2) With radiator cap removed, run engine until upper radiator hose is hot (this shows that thermostat is open and coolant is flowing through system).
- 3) Stop engine and drain coolant.
- 4) Close drain plug. Add water until system is filled and run engine until upper radiator hose is hot again.
- 5) Repeat Steps 3) and 4) several times until drained liquid is nearly colorless.
- 6) Drain system and then close radiator drain plug (1) tightly.